



Broadway Vision Update

CB5 Transportation & Environment Committee

March 25, 2024



Public Realm Feedback Loop



Community Partnership +
Engagement



Open Streets

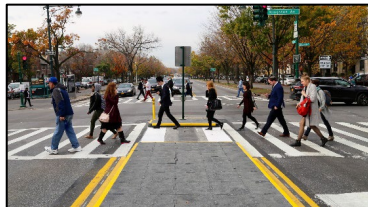

Crossings + Intersections

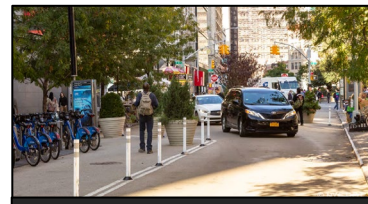

Dynamic Curb + Corridor
Strategies



Premier Public Spaces

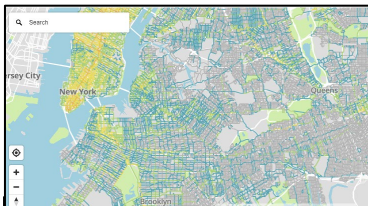

Comprehensive Planning +
Policy



Equity Focused Maintenance



Programming + Concessions

The Corridor



Broadway Vision

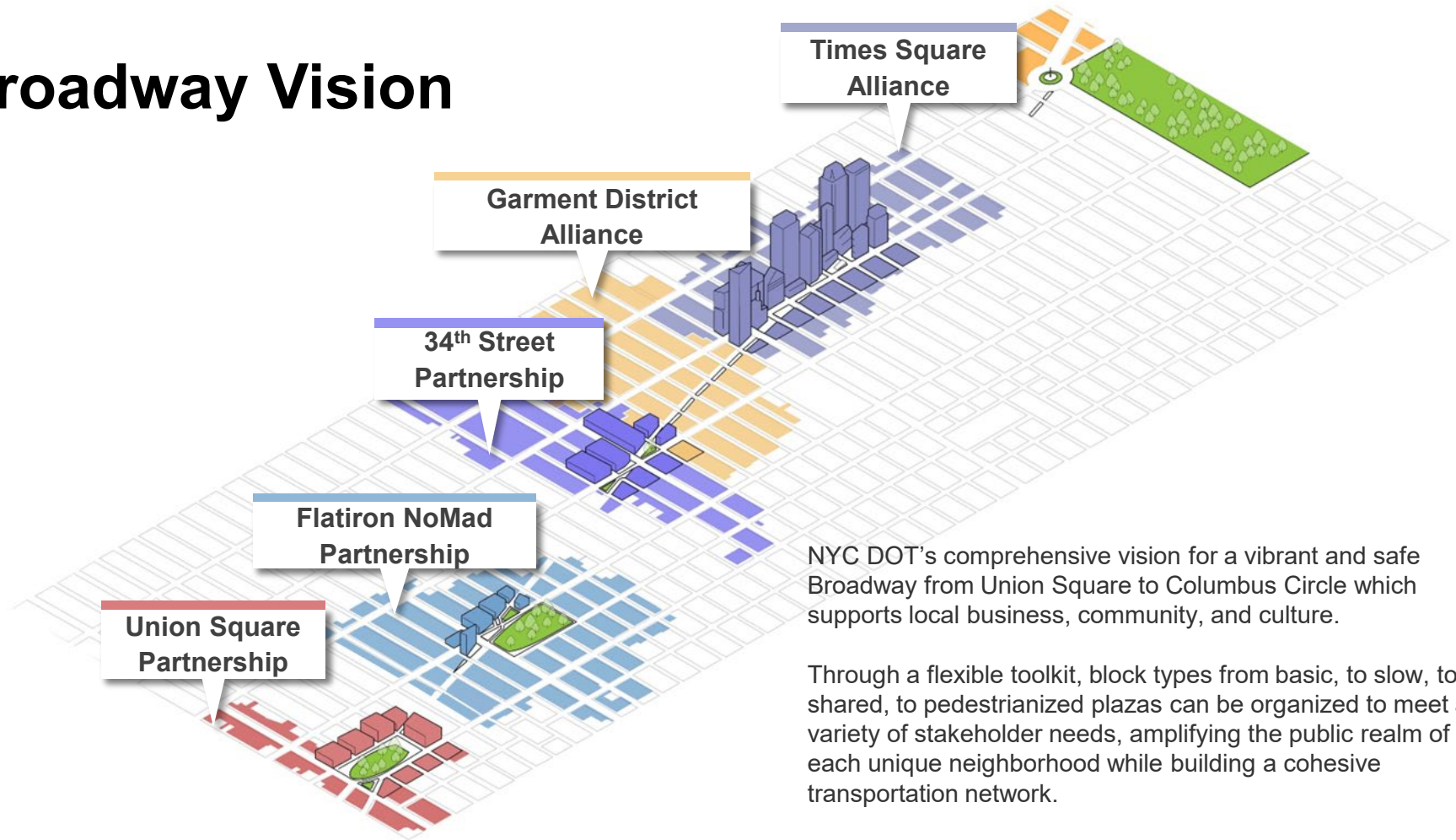

NYC DOT's comprehensive vision for a vibrant and safe Broadway from Union Square to Columbus Circle which supports local business, community, and culture.

Through a flexible toolkit, block types from basic, to slow, to shared, to pedestrianized plazas can be organized to meet a variety of stakeholder needs, amplifying the public realm of each unique neighborhood while building a cohesive transportation network.

Broadway Vision

2024 Planning

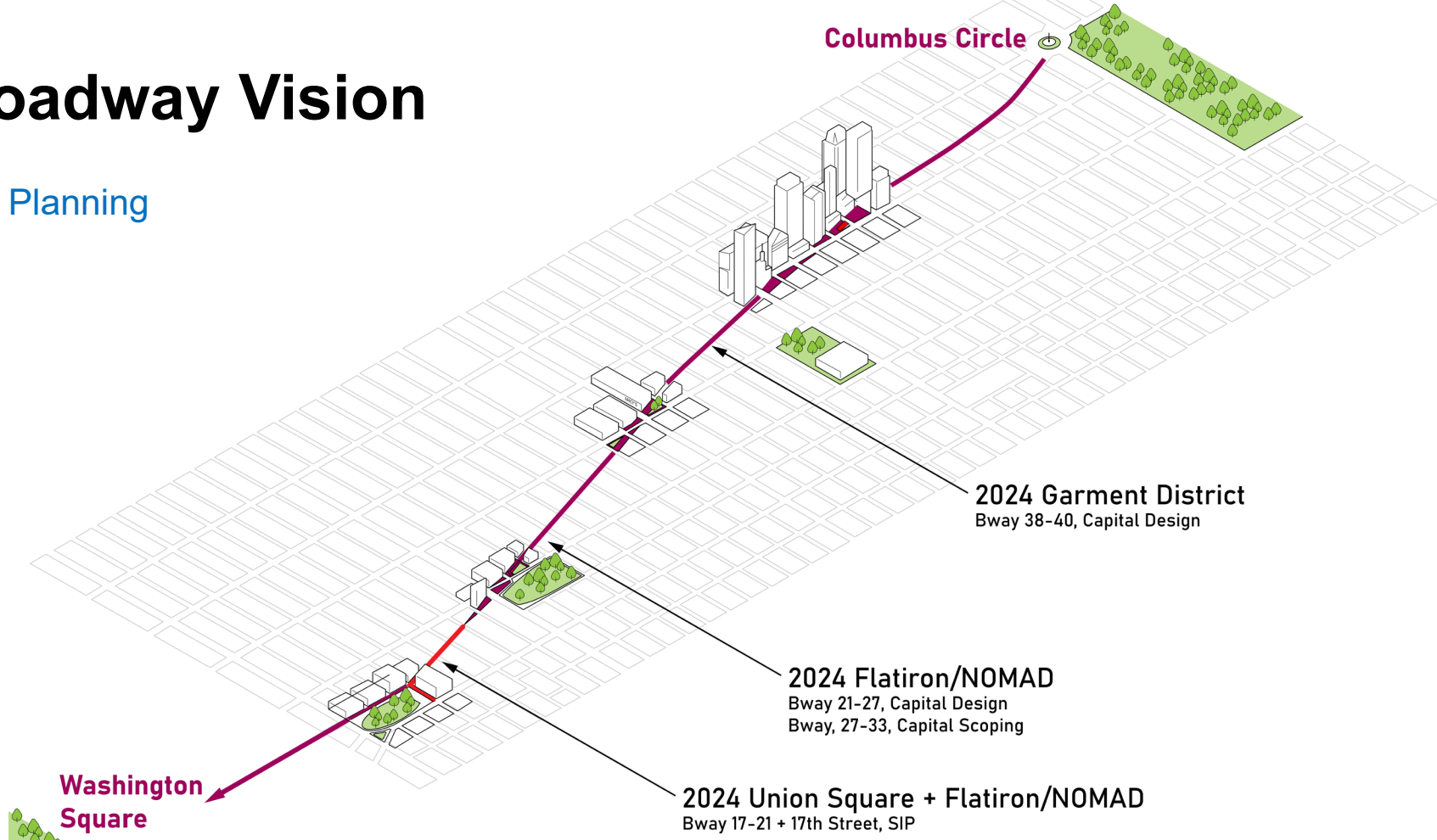

2021 Flatiron

21st – 23rd Shared Streets



2023 Flatiron/NoMad

25th – 27th NoMad Plaza



2023 Flatiron/NoMad

27th-32nd Shared Streets



Corridor Proposal

Broadway, 17th-21st Streets

Project Goals

- Prioritize Pedestrians and Cyclists
- Maintain Necessary Vehicular Access
- Create Additional Public Space
- Formalize Two-Way Bike Connection

DRAFT Design, details still in development

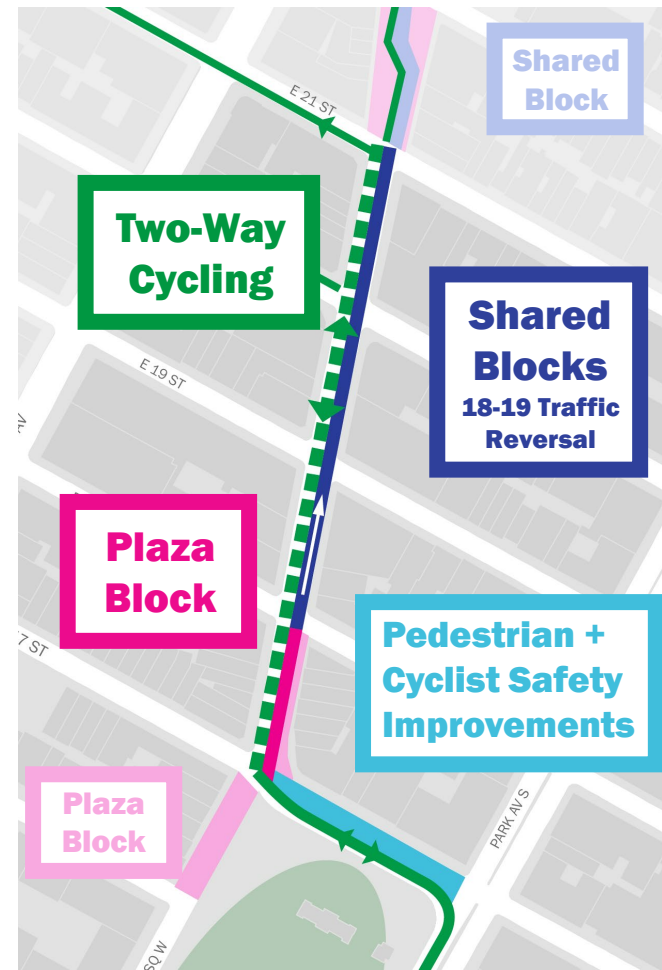

Project Background

Pedestrian Mobility Plan

Broadway – Global Corridor

- Large groups of people moving in all directions; attractions that draw people from around the world
- Suggested sidewalk width of 25'+, clear path of 15'
 - Current sidewalk width ~13' total

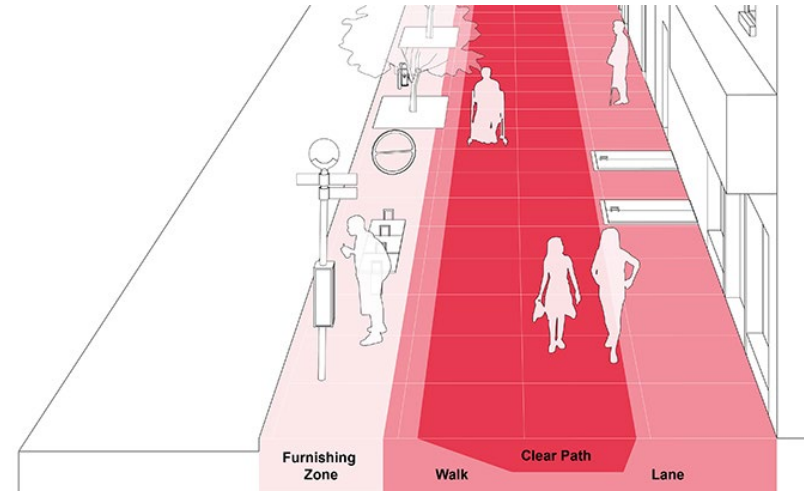

17th Street – Regional Corridor

- Groups of people passing each other; concentration of pedestrian destinations
- Suggested width of 20'+, clear path of 12'
 - Current width ~17' total

Corridor Category	Sidewalk Width	Furnishing Zone	Walk Lane	Clear Path
Baseline Street	8' +	3'	5'	4'
Community Connector	10' +	2'	8'	5'
Neighborhood Corridor	15' +	3'	12'	8'
Regional Corridor	20' +	5'	15'	12'
Global Corridor	25' +	5'	20'	15'

17th Street Congestion

- Cyclists turn through pedestrian crossing at 17th Street and Broadway
- Many pedestrians cross mid-block on 17th Street to access the Park and GreenMarket



Photo Credit: Liz Ligon (2023)

Traffic Volumes

Weekday Morning 9:00-10:00am
Feb 2024

- Volumes are on the decline on Broadway so we need to prioritize the delivery or pick-up/drop-off needs
- During the morning weekday peak there are at least 13 times as many pedestrians as vehicles
- The lowest vehicular volumes are on the 17-18 block with under a car a minute accessing that block



Traffic Volumes

Weekday Afternoon 5:00-6:00pm
Feb 2024

- Volumes are on the decline on Broadway so we need to prioritize the delivery or pick-up/drop-off needs
- During the weekday afternoon peak there are at least 12 times as many pedestrians as vehicles
- The lowest vehicular volumes are on the 17-18 block with about a car a minute accessing that block



Traffic Volumes

Weekend 12:30-1:30pm
Feb 2024

- Volumes are on the decline on Broadway so we need to prioritize the delivery or pick-up/drop-off needs
- During the weekend peak there are at least 20 times as many pedestrians as vehicles
- The lowest vehicular volumes are on the 17-18 block with a car a minute accessing that block



Public Engagement

DOT Public Survey

- Open 8 weeks: Aug. 21st – Oct. 12th

On-Street Public Sessions with Street Ambassadors

- Mon. 8/21, 11a-5p at Broadway & 20th St
- Wed. 8/23, 12-6p at Union Square Greenmarket
- Fri. 8/25, 11a-5p at Broadway & 17th St.

Union Square Partnership Community Opinion Survey

- Summer 2023



Public Survey Results

- **396** survey responses
- **69%** use the corridor everyday or several times a week
- **51%** bike or scooter when on the corridor
- **61%** of cyclists experience conflicts with vehicles
- **64%** of pedestrians think sidewalks are too crowded



Public Survey Results – Visioning

Which amenities and traffic calming elements would you like to see?

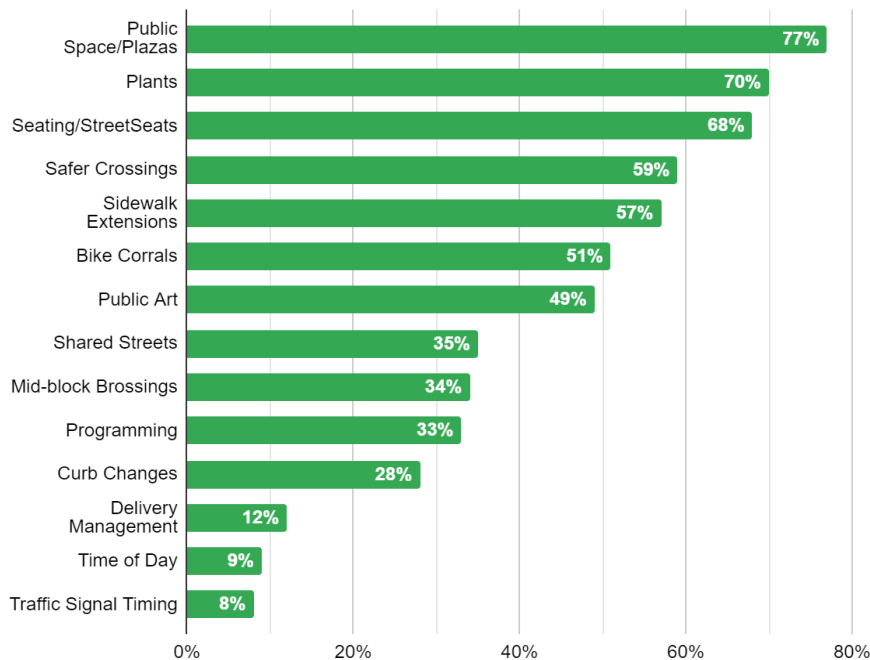

91%

would like to see a Plaza Block

89%

would like to see two-way cycling on the corridor

Public Survey Results – Experience

Pedestrian Experience

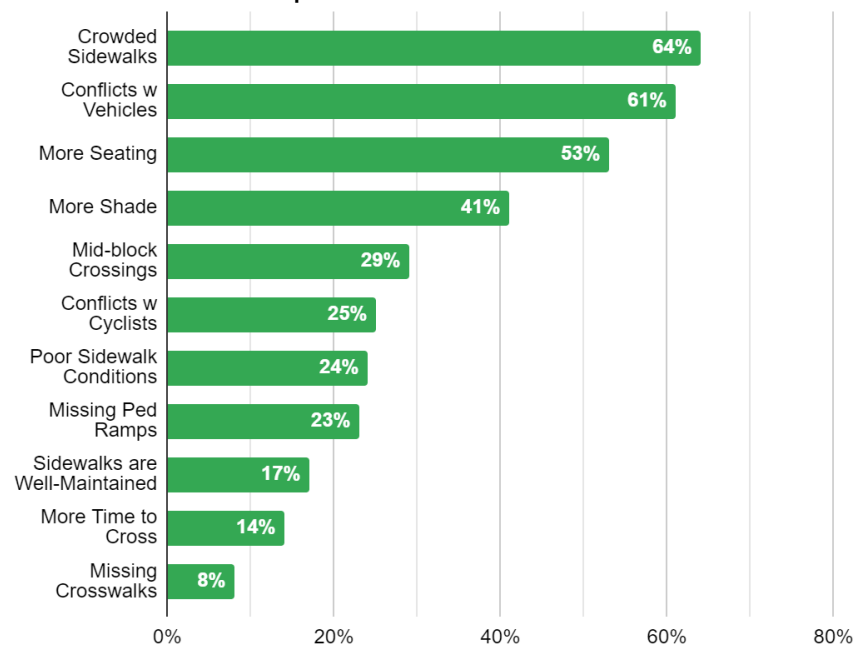

Cyclist Experience

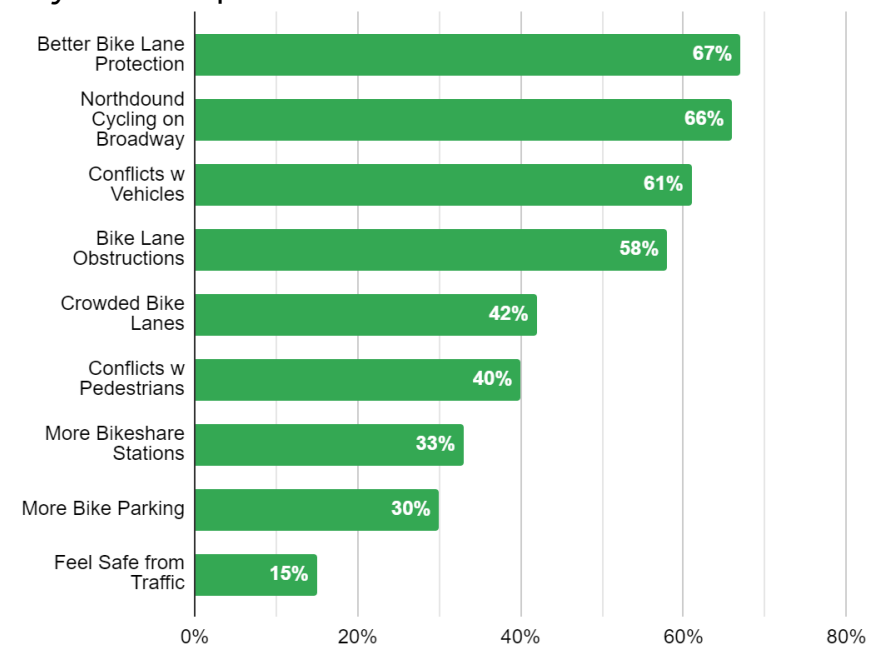

Stakeholder Coordination

- Flatiron/NoMad BID + Union Square Partnership: ongoing coordination
- Greenmarket: 2/29, 3/19
- Stakeholder walkthroughs: 3/7, 3/11
 - Included adjacent building owners and management, and Paragon Sports and other commercial establishments
- Parks: 3/8
- FDNY: 3/19, 3/26
- DSNY: 4/5-4/11



The Proposal

3

Corridor Proposal

Broadway, 17th-21st Streets

Project Goals

- Prioritize Pedestrians and Cyclists
- Maintain Necessary Vehicular Access
- Create Additional Public Space
- Formalize Two-Way Bike Connection

DRAFT Design, details still in development

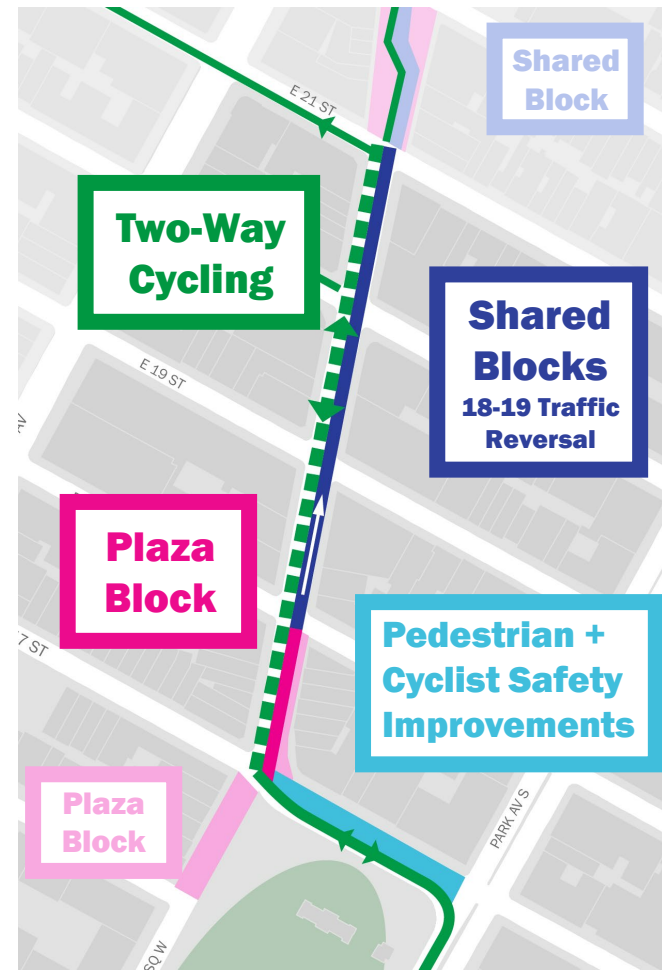

Shared Block

Broadway, 20th – 21st Street

- Increase pedestrian circulation space and public space
- Maintain southbound vehicular access
- Maintain curb access for loading
- Make connection to bike lane on 21st St.



DRAFT Design, details still in development

Shared Block

Broadway, 19th – 20th Street

- Increase pedestrian circulation space and public space
- Remove CitiBike from this block (relocate to 18-19)
- Maintain southbound vehicular access
- Maintain curb access for loading

DRAFT Design, details still in development

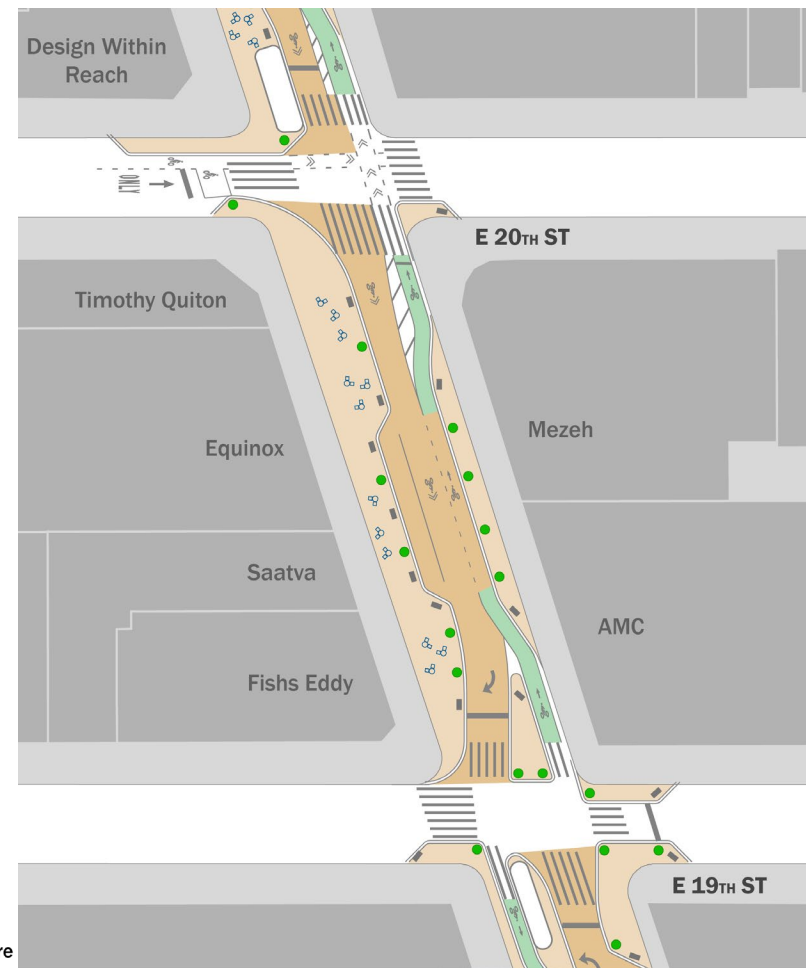

Shared Block

Broadway, 18th – 19th Street

- Reversal to northbound only for vehicles
- Relocate and expand CitiBike station from east side of 19th – 20th to west side of 18th – 19th
 - Reduce maintenance needs where there is limited BID coverage
- Maintain curb access for loading

DRAFT Design, details still in development

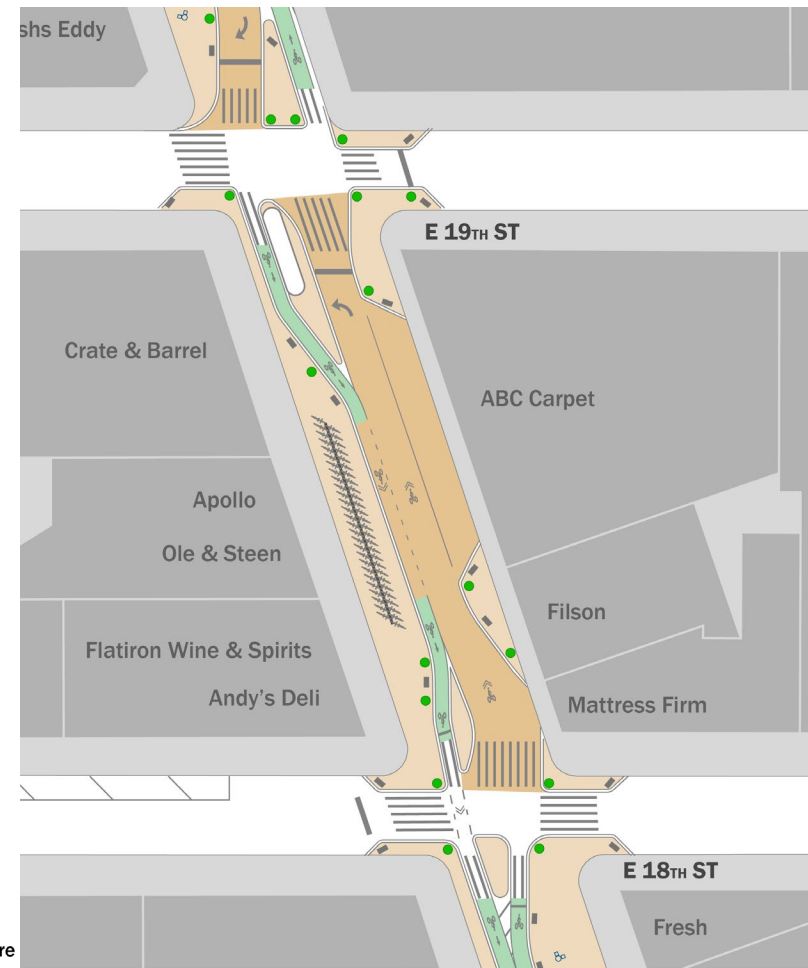
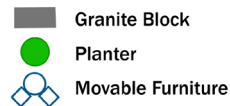

Plaza Block

Broadway, 17th-18th Street

- Formalize northbound bike connection with 2-way bike path through the plaza
- Calm bike traffic with pinches and mid-block pedestrian crossing
- Protects and guides contraflow cyclists through the intersection
- Expand public and programmable space

DRAFT Design, details still in development



17th Street Improvements

E. 17th Street, Broadway – Park Ave S

- Clarify intersection and bike connections at Broadway & E. 17th St
- Create more pedestrian circulation space
- Add mid-block crossing through the bike lane
- Relocate and extend CitiBike
- Maintain GreenMarket parking

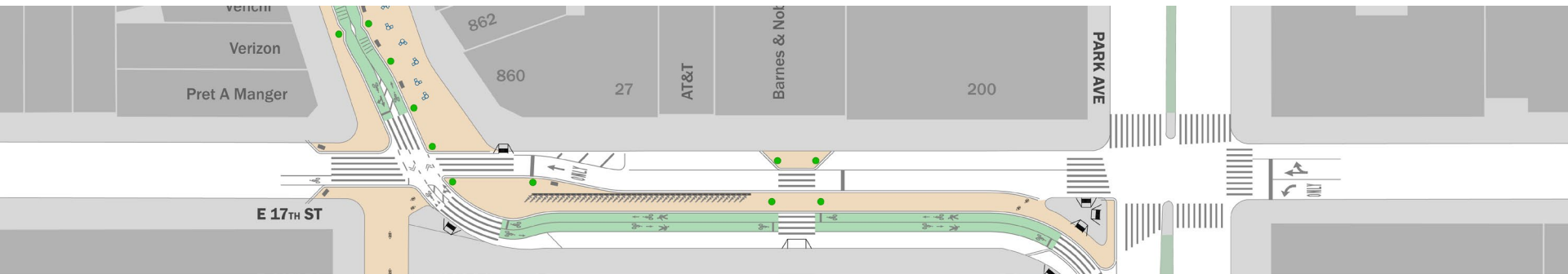

Operations

4

Traffic Network Changes

Broadway, 17th-19th Streets

FDNY

- Westbound access: northbound Broadway to 19th St.
- Eastbound access unchanged

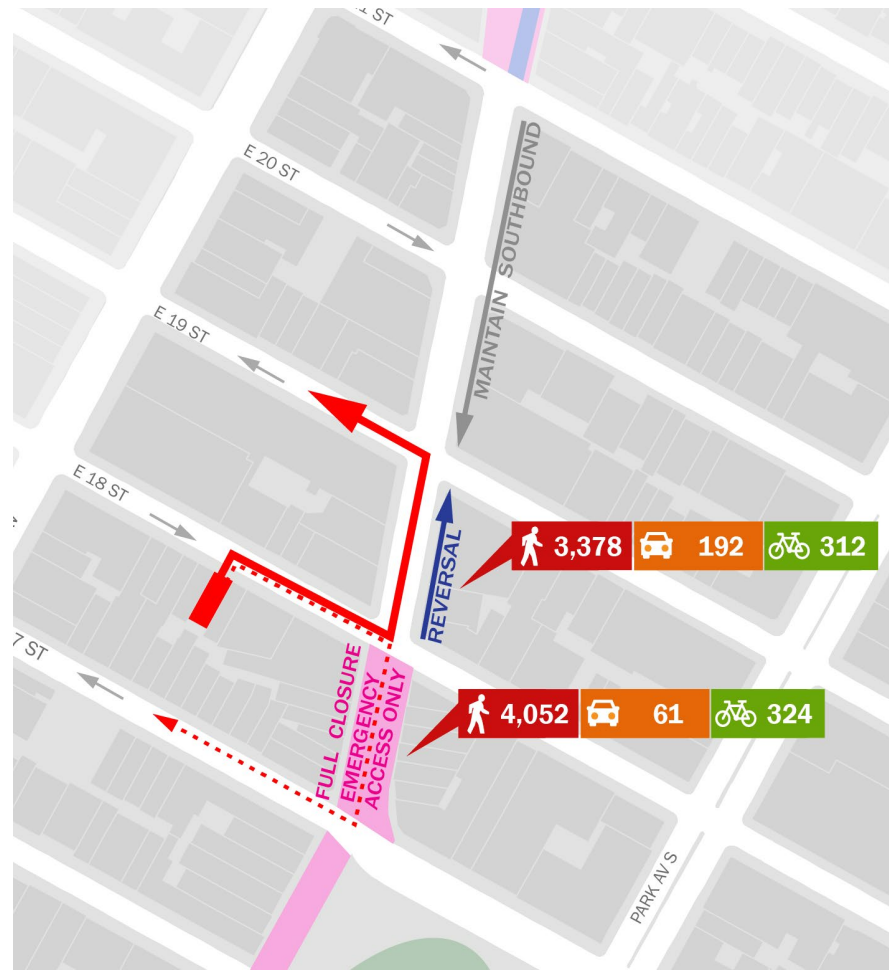

DRAFT Design, details still in development

Traffic Network Changes

Broadway, 17th-19th Streets

18th Street:

- Southbound vehicles on Broadway use 5th Ave to loop around to

17th Street:

- No vehicle access on Broadway, 17th-18th
- Plaza re-routes



DRAFT Design, details still in development

Curb Management

Existing

Broadway

- 710 Linear Feet of Parking
- ~35 parking spots

Numbered Streets

- Commercial Metered Parking



DRAFT Design, details still in development

Curb Management

Proposed

Broadway

- 200 Linear Feet of Parking (-510 LF)
- ~10 parking spots (-25 spots)

Numbered Streets

- **+1,335** Linear Feet of additional evening All Vehicle Metered Marking
- **+67** All Vehicle Metered Parking spots

DRAFT Design, details still in development

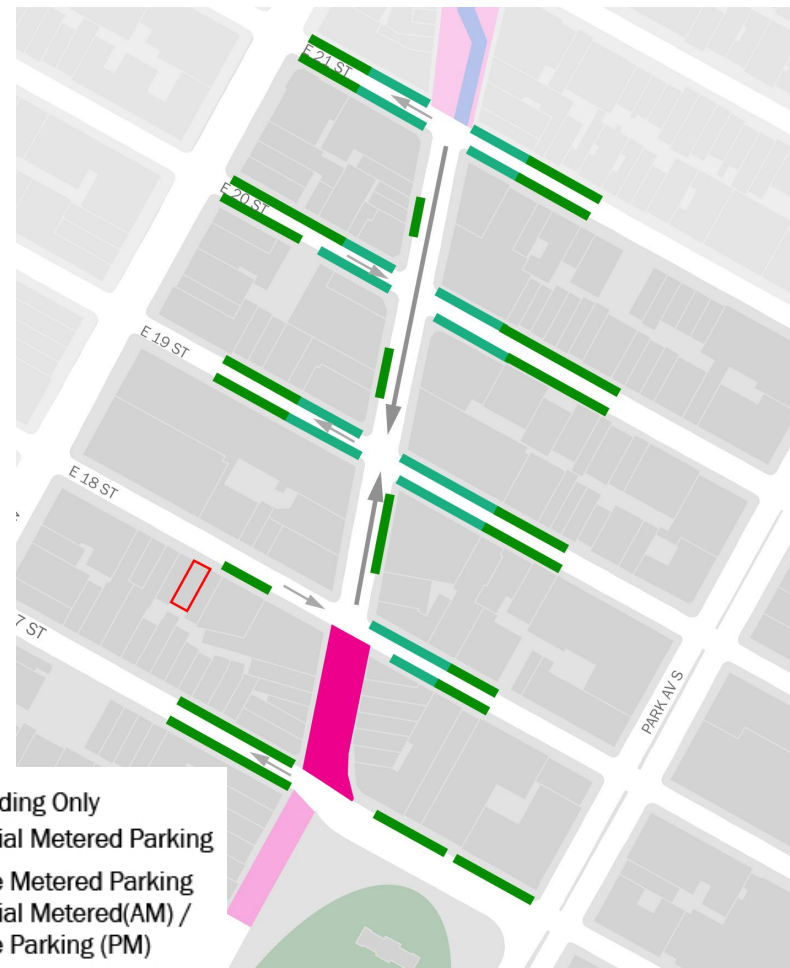
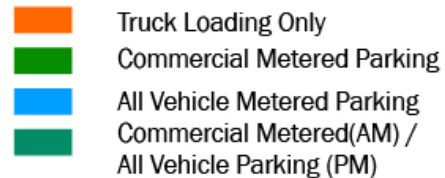

Project Schedule

Early March	Stakeholder outreach + design scheme presentations Design development
Mid-March	Milling and repaving
Late March	CB TC
Early April	CB FB
Spring/Summer	Implementation
Late Summer	Post-implementation educational outreach about changes and how to use space

Thank You!

Questions?



NYCDOT



nyc_dot



nyc_dot



NYCDOT

Traffic Volumes

Weekday Morning 9:00-10:00am
Feb 2024



1

Traffic Volumes

Weekday Afternoon 5:00-6:00pm
Feb 2024



Traffic Volumes

Weekend 12:30-1:30pm
Feb 2024



GreenMarket Operations

